

Layout
Scale 1:500

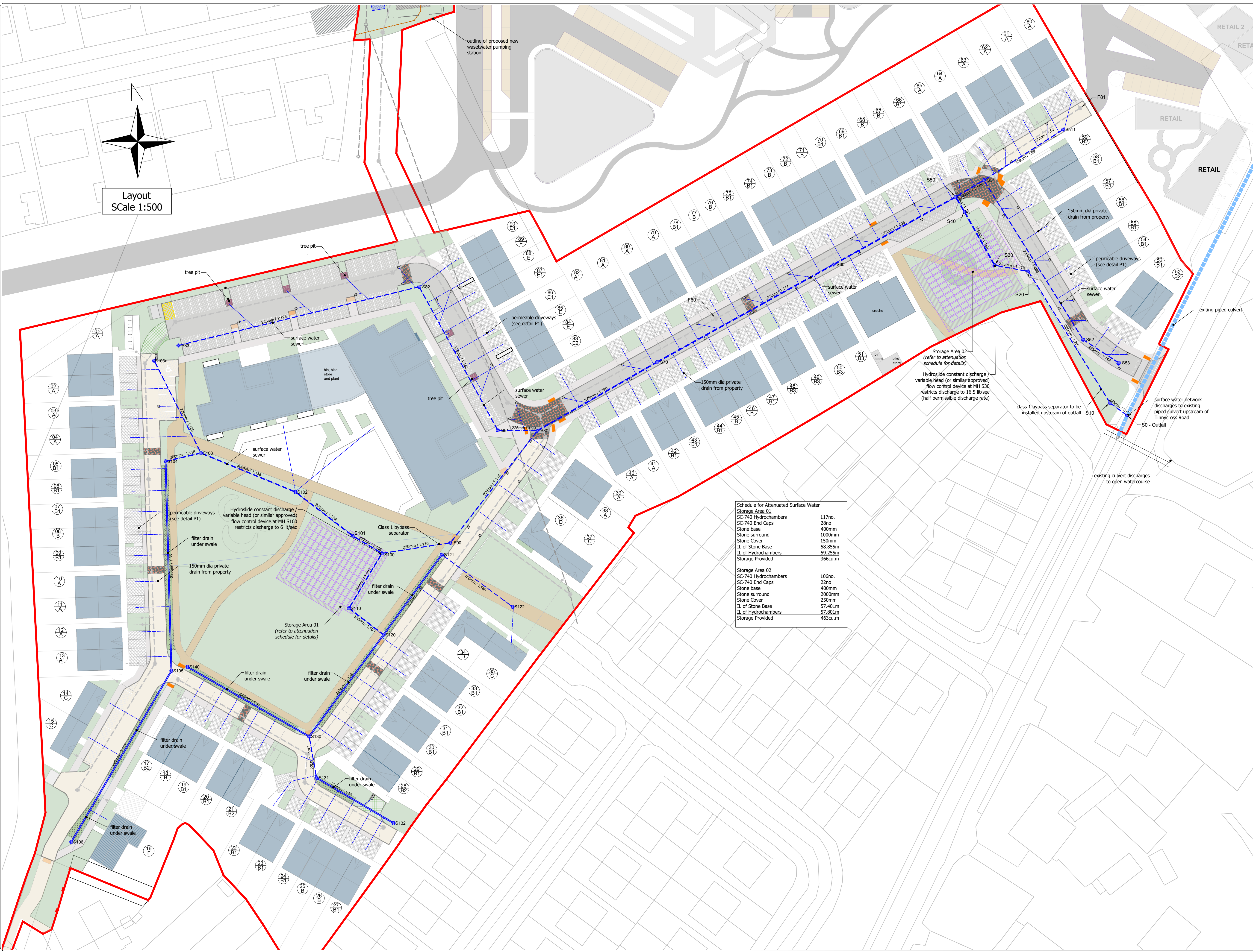

Schedule for Attenuated Surface Water	
Storage Area 01 (refer to attenuation schedule for details)	
SC-740 Hydrochambers	117no.
SC-740 End Caps	28no
Stone base	400mm
Stone surround	1000mm
Stone Cover	150mm
IL of Stone Base	58.855m
IL of Hydrochambers	59.255m
Storage Provided	366cu.m
Storage Area 02 (refer to attenuation schedule for details)	
SC-740 Hydrochambers	106no.
SC-740 End Caps	22no
Stone base	400mm
Stone surround	2000mm
Stone Cover	250mm
IL of Stone Base	57.401m
IL of Hydrochambers	57.801m
Storage Provided	463cu.m

- GENERAL**
- Datum for levels is OS Malin Head.
 - Verify existing levels prior to commencement of works. Report any discrepancies immediately to the Employer's Representative.
 - The locations shown for existing services are indicative only and may not be accurate. Furthermore, uncharted services may also be present. The Contractor should assume the existence of services unless proven otherwise.
 - It is the Contractor's responsibility to determine the existence and precise location of any service located within the site. All works shall be carried out in strict accordance with the document 'Code of Practice for Avoiding Danger from Underground Services' as published by the Health and Safety Authority.

- SURFACE WATER**
- The Specification for surface water drainage works shall be Specification for Roadworks published by Transport Infrastructure Ireland.
 - All surface water drains and sewers to be constructed in accordance with Detail D1.
 - Discharge pipes from gullies to drains and sewers shall be 150mm dia. Saddle connection for discharge pipes in accordance with Detail D3.
 - Chambers to be 1200mm dia. PCC in accordance with the 'Code of Practice for Chamber and Gully Top Installations' published by Laois County Council.
 - Road gullies shall be in accordance with TII Detail CC-SCD-00510 and CC-SCD-00512.
 - Separators to be installed in accordance with Detail D5 and manufacturer's recommendations.
 - Each house to be served by a separate drain of min diameter 100mm dia. and laid to a minimum grade of 1 in 100.
 - Swales to be constructed in accordance with Detail D16.
 - Proposed surface water sewers to be Twinwall.

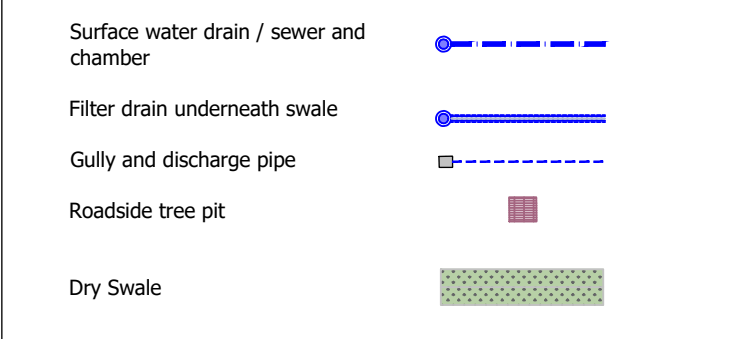

DMS-23 DMS-24

OS mapping reproduced under licence.
This drawing is not to be reproduced without the written permission of Kilgallen and Partners. Copyright.

REV	DATE	BY	DETAILS
PL2	05/04/23	SC	Issued for LRD application
PL1	10/10/22	SC	Issued for pre-planning consultation
PR2	23/09/22	SC	Issued for IW pre-connection enquiry
PR1	03/05/22	AB	Issued for discussion

STATUS
FOR PLANNING APPLICATION PURPOSES ONLY. NOT TO BE USED FOR ANY OTHER PURPOSE.

CLIENT
JOHN FLANAGAN DEVELOPMENTS

PROJECT
PUTTAGHAN LANDS, TULLAMORE

TITLE
SURFACE WATER DRAINAGE - GENERAL LAYOUT

KILGALLEN & PARTNERS
CONSULTING ENGINEERS
E-mail: info@kilgallen.ie, Web: www.kilgallen.ie

KYLEEPROBE
WELL ROAD
PORTLADISE
T +353 56 866 2860

DANVILLE BUSINESS PARK
KILKENNY
+353 56 777 0190

DRN:	DRAWING NO.:	REV.:
SC	22009-C-DR-201	PL2
CHWD:	SCALE:	SIZE:
PB	1:500 @ A1	A1
DATE:	03/05/2022	